



PRODUCT BULLETIN 36103

MineCruiser Door Protection

Date: 07-07-2021

Prepared for: MineCruiser owners and end users

Prepared by: Australian Mining Equipment

Revision: A

Communication: MineCruiser Mk7 and Mk6 Door Design

Due to an incident whereby a passenger travelling in an underground transporter has suffered serious arm injuries, it has been identified the risk of injury is increased where low-style doors are fitted on the MineCruiser personnel transporters.

MineCruiser Mk7

The Minecruiser door design has a low and high door design for the MineCruiser Mk7.

The high door weldments are available for direct replacement with a low door as part numbers below;

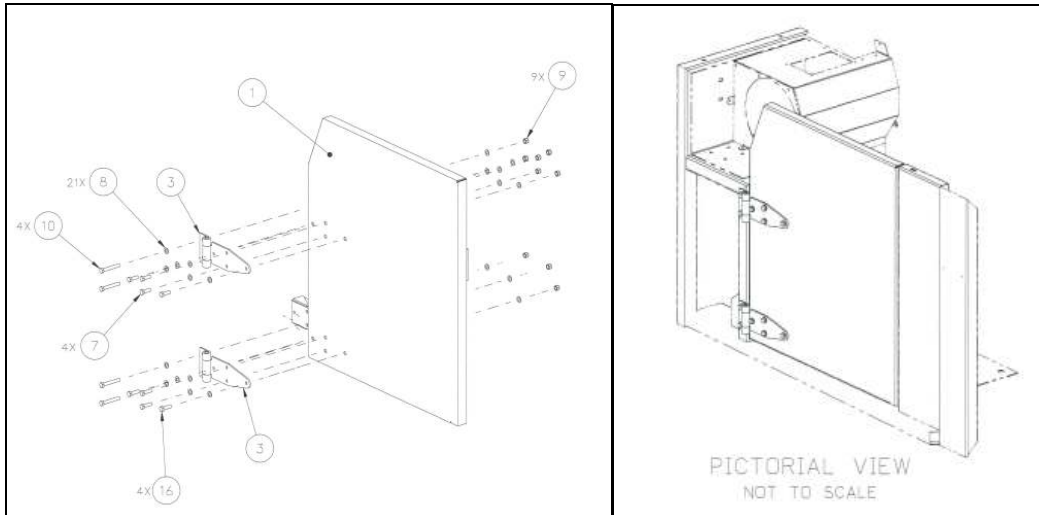

Item 1 part number 7-121784-700 (Passenger side) & 7-121785-700 (driver's side)

Alternatively door extension pieces may also be procured as a kit, including fasteners.

Mk7 Door extension Drivers side P/N 7-026560-700

Mk7 Door extension Off drivers side P/N 7-026561-700

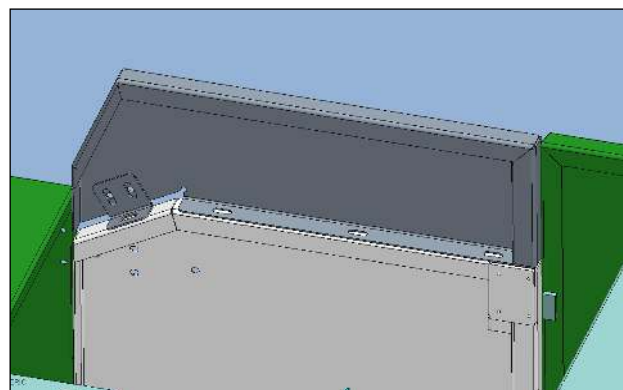
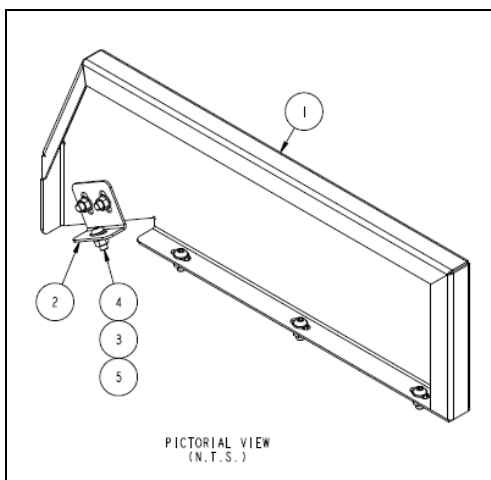

Mk7 Door Extension pieces – Installation onto low style doors will require the four mounting holes to be drilled along the top surface

MineCruiser Mk6

The Mk6 has two variants of door, which are both a low style of door.

The Troop or side seater variant may now be replaced with a high door versions,

Drivers Side Door Weldment P/N 7-026544-700.

Off Drivers Side Door Weldment P/N 7-026545-700

Alternatively the troop may also be installed with extension pieces as per the below

7-026562-700 DS Cabin Door Ext Assy
7-026563-700 ODS Cabin Door Ext Assy

DS High Door 7-026544-700
ODS High Door 7-026545-700

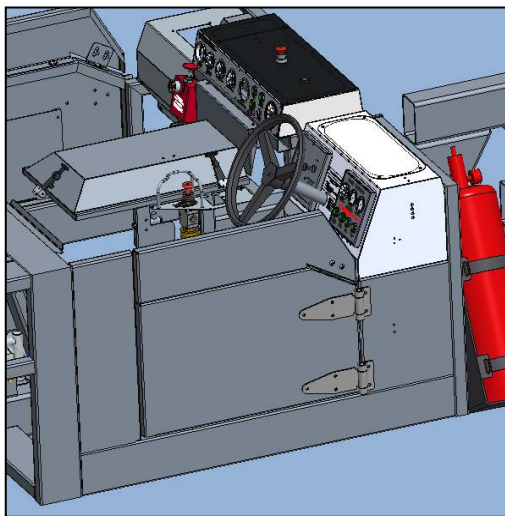

Mk6 Door Extension (Troop)

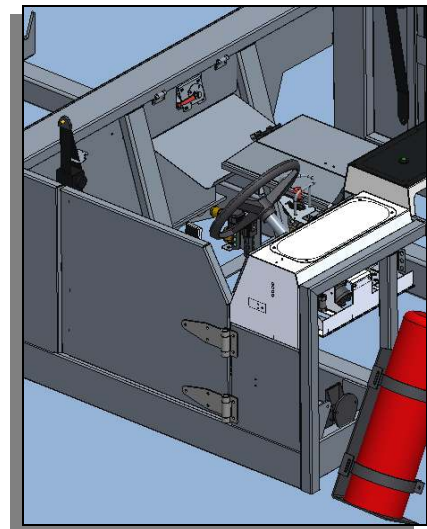

Mk6 High Door (Troop)

For the Ute version and forward / rearward facing Mk6 MineCruiser or older variants, please contact AME Product Management.

The Doors supplied for the Mk6 do not come with hinge holes pre-drilled, and must be matched drilled to suit installation.

Recommended Action:

- Where Low style doors are installed, they should be considered for replacement with a high style door or fitted with a door extension to provide improved protection of operators and passengers.

Enquiries and orders may be placed via correspondence with orders@amequip.com.au.
Please note that a high demand may be on these parts and hence a lead time may apply

Please distribute this bulletin to all relevant personnel

Australian Mining Equipment Contacts in respect to this bulletin:

Product Engineer
Workshop Manager NSW
General Manager QLD
Engineering Manager

Bill Davidson 0409562385
Garrad Latham 0407272296
Doug Woodham 0437436939
Ben de Rooy 0439714737